





QUICK MANUAL PROFORT PICCOLO® AIR

100% DANISH DEVELOPED AND PRODUCED



Guide to installation and set-up of the Profort Piccolo® AIR

WHAT DOES A PICCOLO® AIR PROTECTION SYSTEM CONSIST OF?

<p>A</p>  <p>Piccolo® AIR Receives signals from the remote control and from the sensors. Sends signals to alarm units and mobile telephones.</p>	<p>B</p>  <p>Detektor Place the detector at object.</p>	<p>C</p>  <p>Remote control (Extra equipment) Used for connecting /disconnecting the Piccolo® AIR.</p>
---	--	--

HOW DOES THE PICCOLO® AIR WORK?



On the following pages we go through how to install a SIM card in the Piccolo® AIR unit; how to mount the wireless detector; and how to set up the protection system to send alarms to your mobile or smartphone.

HOW TO GET YOUR PICCOLO® AIR UNIT READY:

SIM card

Use a normal microSIM card from a chosen operator (Not from the mobile organisation '3'). Note the phone number of the card. In future, use it when you send text messages to the unit.

- 1. Check the microSIM card.** Place the microSIM card in a normal mobile phone. Check that you can call and send/receive messages to/from the phone.
- 2. Deactivate the PIN code.** Whilst the microSIM card is in the phone, you need to set the microSIM card to NOT ask for the PIN code (perhaps see how in the manual of your mobile telephone).
- 3. Install the microSIM card.** Remove the microSIM card and mount it in the Piccolo® AIR unit (Fig 1 and fig. 2A).

Fig. 1 REMEMBER to turn the SIM card the right way up. See marking by card holder.

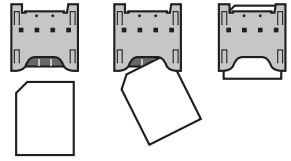

Press the SIM card into the holder and push it carefully in place as shown.

Power

The Piccolo® AIR unit can be supplied with power in 3 ways:

12/24V DC: Use the screw terminal (Fig. 2B)

230V: Use the included converter

Battery: It is possible to mount a battery in case of power failure (Fig. 2C)

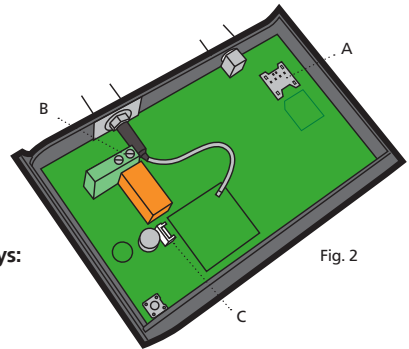
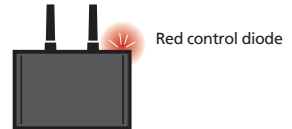

Fig. 2

1. Mount the back-up battery in the plug (optional) (Fig. 2C).
2. Mount the power supply and switch on the power to the Piccolo® AIR unit.
3. The unit gives a short beep and the red control diode is lit for approximately 30 seconds.
4. Afterwards the control diode will flash with a single flash every 3 seconds. It shows that the Piccolo® AIR unit is ready and functions correctly.



Red control diode

Placing of the Piccolo® AIR unit

The Piccolo® AIR unit must be placed centrally in relation to the installed detectors. After the detectors have been placed at the objects, place the Piccolo® AIR unit in the middle of the installation.

HOW TO GET THE REMOTE CONTROL READY:

A battery from the factory is installed.

See on the back of the unit which button switches the alarm on.





A full suite of detectors solve any task:

Paintings



Sculptures and other free-standing objects



Showcases

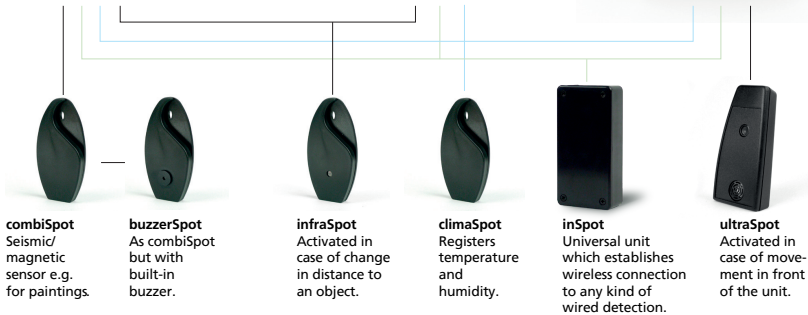

HOW TO CONNECT ALARM UNITS AND REMOTE CONTROLS:

Briefly press down the little button in the Piccolo® AIR unit (Fig. 3A). The unit sends out a series of beeps. It is now ready to receive encoding of the first detector.

Release an alarm by activating the detector.

The Piccolo® AIR unit acknowledges by beeping quickly and then stopping the beeping. Screw the cap back on. The first detector is now activated.

Connect more units

It is possible to connect more detector to the same Piccolo® AIR unit by repeating the process for the additional detectors.

Connect remote control

Connect optionally remote controls in the same way – just press the 'unlock' button on the remote control instead of demounting the cap. The remote control is hereby connected to all the alarm units which the Piccolo® AIR unit controls.

Errors or changes in the settings

Do you wish to change the settings or have you made a mistake along the way, the Piccolo® AIR unit needs to be reset (see how in the manual of the Piccolo® AIR unit). Afterwards you have to start all over as described above.

Test that the installation works

Activate a detector without having disconnected the alarm. Test that the alarm works as described on next page.

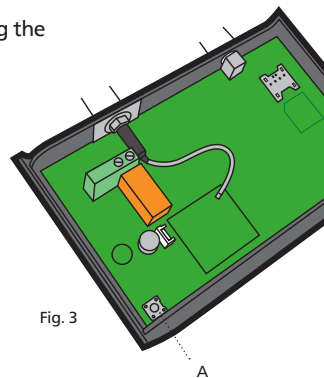

Fig. 3



The Piccolo AIR unit acknowledges with sound signal.



HOW TO CONNECT A MOBILE TELEPHONE FOR RECEPTION OF ALARMS

Send text to the Piccolo® AIR unit with following message: N1[space][number of mobile phone for reception of alarms] E.g.: N1 22334455

Would you like to connect more phones, then repeat the process. Just change N1 to N2, N3 and so on for every extra mobile you connect.

How to change the text in the detector: Note the 6-digit number that appears in the alarm. Send a text message to the unit with the text "DT[space][detector number][space][alarm text]". E.g. "DT 100123

HOW ARE ALARMS RECEIVED?

Output:

When an alarm comes in the the relay output activate. Connect external alarm system and/or external siren to this output.

The relay is activated for 10 seconds after an alarm.

Text message:

You receive a text message on the phone/s connected to the Piccolo® AIR unit.

HOW TO CONNECT/DISCONNECT THE ALARM SYSTEM WHEN FUELLING

Remote control:

Is a remote control connected, press the Alarm OFF button.
The Piccolo® AIR unit acknowledges with two beeps.

When a detector is activated, the alarm system is activated again by pressing the Alarm ON button. The Piccolo® AIR unit acknowledges by beeping 4 times.

Text message:

Use a mobile telephone.

Send a text with the message 'OF' (NOTICE! Spelled with only one F) for the phone number of the Piccolo® AIR unit. You can also use a mobile phone which is not connected to the alarm system.

When the detector is silent again, the alarm system is activated by sending a text with the message 'ON' to the phone number of the Piccolo® AIR unit.



For further info, see the instruction film and FAQ on our website.

**Do you need further help or are you interested in advanced functions?
Read more in the manual on www.profort.dk**